

OPURES

Instruction Manual

Model: OP2200V

Alexa Voice Control Wi-Fi Speaker



OPURES

SHENZHEN OPURES TECHNOLOGY CO., LTD

Add: Room 206, No.535 Building, Bagua 2nd road, Futian District, Shenzhen City, China.

Tel: +86-755-22933319

E-mail: sunny.cao@opures.com
mc.fong@opures.com

www.opures.com

2) Why not sound when Request Songs from APP?

Please check whether the router has properly connected to the Internet.

Please check whether the speaker is muted or the streamed music is still buffering.

3) Why not sound when external player connect with the speaker to play songs ?

Please check whether the player on your mobile phone or PC is set to local play.

Please check if the audio cable is properly connected.

12.Note

1) The speaker should avoid water and avoid fire, avoid collision ,drop and break;

2) During lightning storms or if you do not use the speaker for a long time, please disconnect the power adapter from power supply.Please turn off the speaker’s power supply first when disconnect power, then remove the adapter plugs and properly place the speaker;

3) Please do not arbitrarily change the speaker power adapter, if you really need to change,please choose adapter with the appropriate specifications.The standard power adapter of the speaker with 100-240V, 50 /60 Hz input , DC 15V/1.5A output.

4) The manufacturer has the right to remodel and upgrade functions without updating the notice.

13.FCC

This device complies with part 15 of the FCC Rules. Operation is subject to the following two conditions: (1) This device may not cause harmful interference, and (2) this device must accept any interference received, including interference that may cause undesired operation.

Note: This equipment has been tested and found to comply with the limits for a Class B digital device, pursuant to part 15 of the FCC Rules. These limits are designed to provide reasonable protection against harmful interference in a residential installation. This equipment generates uses and can radiate radio frequency energy and, if not installed and used in accordance with the instructions, may cause harmful interference to radio communications. However, there is no guarantee that interference will not occur in a particular installation. If this equipment does cause harmful interference to radio or television reception, which can be determined by turning the equipment off and on, the user is encouraged to try to correct the interference by one or more of the following measures:

-Reorient or relocate the receiving antenna.

-Increase the separation between the equipment and receiver.

-Connect the equipment into an outlet on a circuit different from that to which the receiver is connected.

-Consult the dealer or an experienced radio/TV technician for help.

Any Changes or modifications not expressly approved by the party responsible for compliance could void the user's authority to operate the equipment.

This equipment complies with FCC radiation exposure limits set forth for an uncontrolled environment. This equipment should be installed and operated withminimum distance 20cm between the radiator & your body.

Contents

1.Safety	2
2.Alexa Voice Cotrol Wi-Fi Speaker.....	2
2.1 Product introduction	2
2.2 Control funtion.....	3
2.3 Software icon	4
3.Prepare.....	6
3.1 What you need.....	6
3.2 Download OPURES app to yours ios or android device	6
3.3 Connect power and switch on	7
4.Connect OP2200V to your home Wi-Fi network	7
4.1 Set up through an ios or android device	7
5.Direct connect to WiFi speaker	10
6.Add more WiFi speaker	12
7.Bluetooth mode.....	12
8.Restore factory settings	13
9.Product specifications.....	14
10.Product packing list	15
11.FAQ.....	15
12.Note	16
13.FCC	16

1.Safety

Only use attachments/accessories specified by the manufacturer.

- Use only power supplies listed in the user manual.
- The product shall not be exposed to dripping or splashing.
- Do not place any sources of danger on the product (e.g. liquid filled objects, lighted candles).
- Where the mains plug or an appliance coupler is used as the disconnect device, the disconnect device shall remain readily operable.

Warning

- Never remove the casing of this apparatus.
- Never lubricate any part of this apparatus.
- Never place this apparatus on other electrical equipment.
- Keep this apparatus away from direct sunlight, naked flames or heat.
- Ensure that you always have easy access to the power cord, plug or adaptor to disconnect this apparatus from the power.

Risk of overheating! Never install this apparatus in a confined space. Always leave a space of at least four inches around this apparatus for ventilation. Ensure curtains or other objects never cover the ventilation slots on this apparatus.

2.Alexa Voice Control Wi-Fi Speaker

2.1 Product introduction

OP2200V is the smart audio speaker that enables the Amazon Alexa voice control features. and can play Cloud Music such as from Amzon, Spotify, iHeart Radio, Tidal and DLNA. User can stream music from library to any room in the house and choose the particular device want to play. The system also included Bluetooth feature which user can stream the music from their handheld devices directly.

Amazon Alexa feature can answer your question, read news, reports traffic and weather, provide local information etc.

Far-field voice recognition even when playing music.

Smart interaction technology can give you different emotion feedback with different status when you talking with her.

Immersive sound quality with 360° omni-directional audio, make you enjoy music every where.

Clock display with adjustable brightness.

Wireless

2.4GHz: 802.11b/g/n; Dynamic streaming flow; Connect up to 32 devices

3.5 mm Jack: 0-0.5Vrms, for TV/mobile phone ear Jack

Audio performance

Power output: 4W+8W 1%@THD+N

SNR: 85dB 1 KHZ @ 1W

THD: 0.2% 1 KHZ @ 1W

Input sensitivity: 1Vrms

Input impedance: 6 K Ohm Analog Input

Gain: 12 dB Analog Input

Power Consumption

60% Volume (Pop Music): 7 Hours

StandBy Time: 2~3Days

Power: 11.1V 2200mAh Li-battery

External Power Adapter: AC 100V-240V DC 15V/1.5A 22.5W

Charge time: 3-4Hours

Dimension: L160*W120*H245mm

Frequency response: 80Hz ~ 20KHz @+/- 6dB

Speaker driver

Treble: 1 x 1" 6 Ohm

Mid-Bass: 1 x 3" 4 Ohm

Storage temperature: From-20°C to 70°C(From-4°F to 158°F)

Working temperature: From-5°C to 40°C (From 23°F to 104°F)

Languages: English,German,French,Dutch,Portuguese,Italian,Spanish,Japanese,Korean TraditionalChinese,Simplified Chinese

Music service support: Qingting FM,Himalayan,Douban,TIDAL,Spotify,iHeartRadiond so on.

Gross weight: 1800g

Gift box dimension: L185*W143*H333mm

10.Product packing list

Upon receive,if you find package lack of the following items,please contact the merchant. Sorry for the inconvenience that may have incurred to you.

- 1) OP2200V Speaker
- 2) Power Adapter
- 3) Instruction Manual
- 4) Warranty Card

11.FAQ

- 1) Do I need to connect the router in the APP every time I open the OPURES WiFi Speaker?
If the router WiFi settings are not changed, the speaker will automatically connect to the route when second use,OPURES APP will automatically scan the speaker device that has been connected.

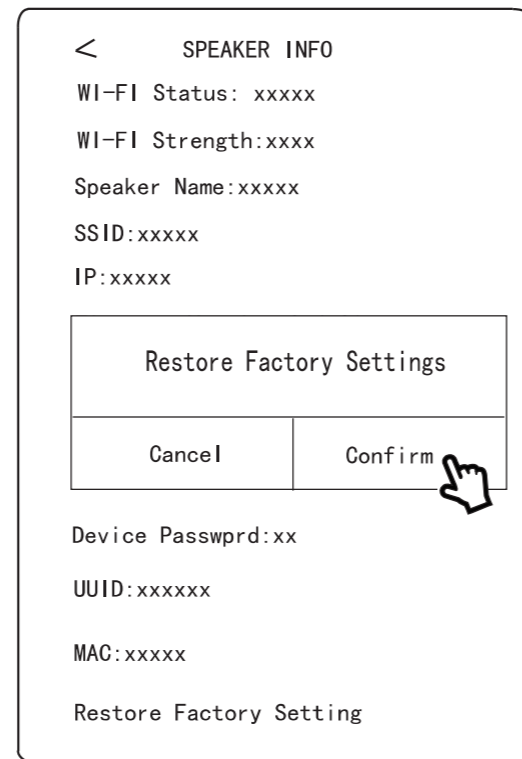
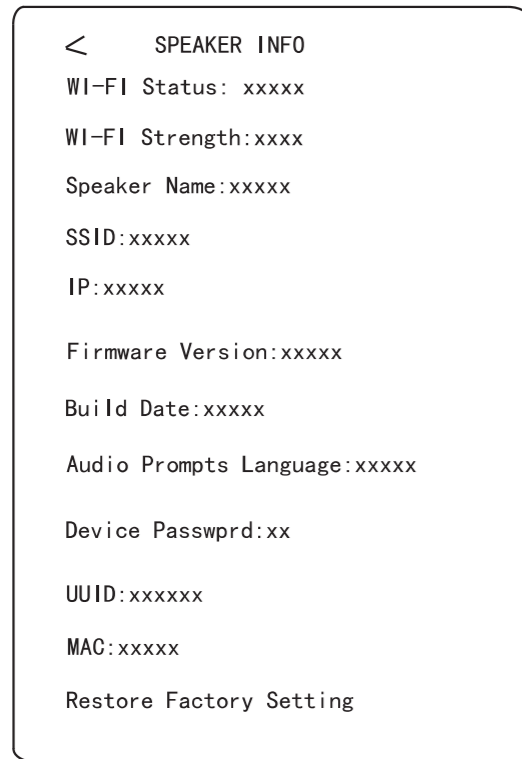

9. Product Specifications

Connect: WiFi Connect, Bluetooth connect, 3.5mm AUX Line in

Network and support

Security format: WEP/WAP-PSK/WPA2-PSK/WAPI Security type: WEP64 /WEP128/TKIP/AES

Streaming protocol: DLNA,UPNP

Sampling rate: 16KHz~192KHz 24bits

Support devices: iOS and Android

Wi-Fi parameter

Wi-Fi standard: 802.11b/g/n

Wi-Fi Frequency range: 2412-2462MHz

Wi-Fi Bandwidth: 20MHz/40MHz

Wi-Fi Speed: 150Mbps (40MHz,Max)

Wi-Fi Max. Distance: 35M (Open Area)

Bluetooth

Bluetooth Standard: Bluetooth 4.1

Bluetooth Frequency range: 2402-2480MHz

Bluetooth profiles: A2DP,AVRCP

2.2 Control function

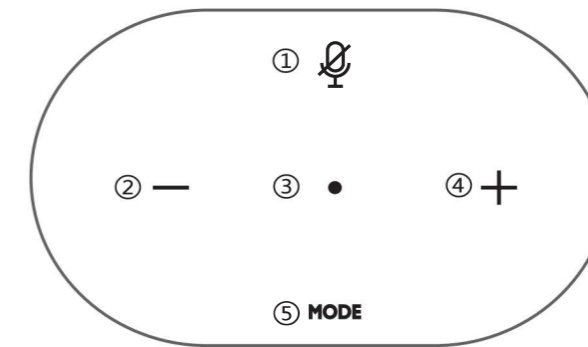

① Mute(LED indicator)

When the ① “  ” button is pressed, the mute indicator light up in red color and disable wake up Alexa.

② Volume down

• Press to decrease volume.

• Press ① “  ” and ② “ — ” at the same time to decrease the screen luminance.

③ ● Near field

Press this button to wake up Alexa manually, Hold to update time.

④ Volume up

• Press to increase volume.

• Press ① “  ” and ④ “ + ” at the same time to increase the screen luminance.

⑤ Mode

Press this button to select the input source: WIFI → Bluetooth → Line in.

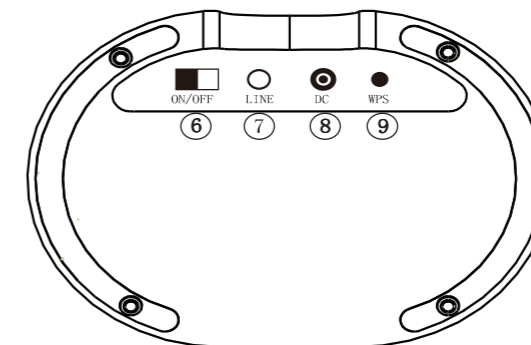

⑥ Power On/Off switch

Slide this button to turn on and turn off the system.

⑦ Audio input

3.5mm Line In

⑧ DC power input

⑨ WPS

Connect WIFI / restore factory / software update

2.3 Software icon

POWER ON/OFF

(1) Power on:

(2) Power off:

(3) Power Volume:

BLUETOOTH

(1) BT Mode:

(2) BT search:

(3) BT connect successful:

(4) BT play:

(5) Disconnect BT:

(6) BT version:

WIFI

(1) Wifi Mode:

(2) Wifi search:

(3) Waiting time update:

(4) Wifi connect successful:

(5) Wifi connect unsuccessful:

LINE

Line in mode:

IUMINACE

Luminance adjust:

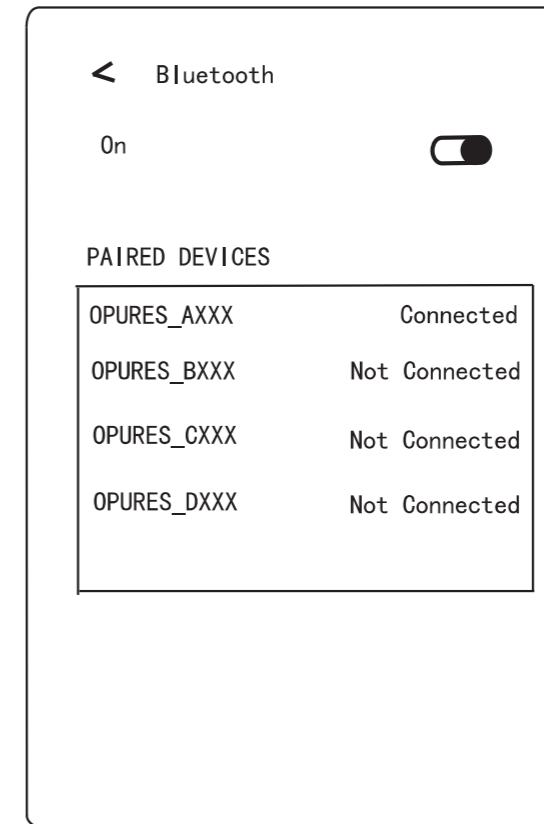

8. Restore factory settings

- 1) In some cases, you may need to reset the speaker to the default setting. For example resetting the WIFI setting.
- 2) Make sure that OP2200V is powered on and connected to the same WIFI network as your smartphone or tablet.
- 3) Make sure that your home Wi-Fi network is connected to the Internet.
- 4) Run speaker set on your IOS or Android smartphone or tablet.
- 5) Change the source to LINE.
- 6) Press and hold the WPS button.
- 7) Device will prompts restore factory by voice.

6.Add more WiFi speakers

- 1) You can add multiple OP2200V Multi-room speakers that connected to the same Wi-Fi network, and set the WiFi speaker to left or right channels according to its placement.
- 2) Go to the DEVICE LIST page, tap the "+" icon on the upper right corner to add devices.
- 3) Make sure that the WiFi Speaker you want to add.
- 4) Connect the Speaker to your home Wi-Fi network(same setup as above).
- 5) Set Multi mode:Press and hold device icon and drag towards another device to pair devices. Until there appears a dotted line, then let go of your hand.You can enjoy music streamed to all speakers in the same group at the same time.
- 6) Set Solo mode: Press and hold device icon and drag down past dotted line.

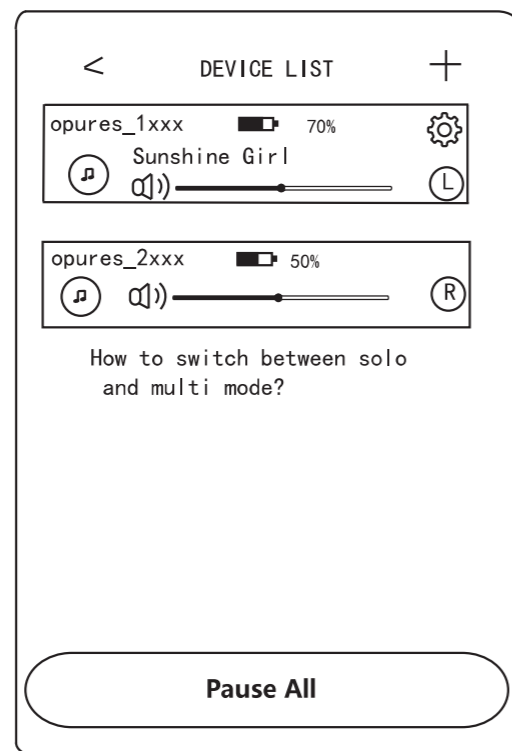

7.Bluetooth mode

- 1) Press the "MODE" button and to select Bluetooth source. Hold for 3 seconds and the Bluetooth search icon will prompt.
- 2) Search the speaker name in the IOS or Android device's Bluetooth settings, touch and pair the speaker.
- 3) Follow the instruction to finish the Bluetooth pairing process.

VOLUME

(1) Volume adjust:

(3) Min vloume:

(5) MIC ban:

(7) LEFT:

(2) Mute:

(4) Max volume:

(6) Stereo:

(8)RIGHT:

TIME

(1) No timezone:

(3) Current time:

(2) Timezone:

(4) Set off screen time:

BATTERY

(1)Recharging:

(3) Battery 100%:

(5) Auto Power-off:

(2) Charged full:

(4) Battery 50%:

VOICE CONTROL

(1) Question searchig:

(3) Not connected Amazon:

(2) Qusetion answering:

(4) Waiting for an answer:

Multiroom Operation

1.Consistent:

2.Incosisent:

MCU update:

Current version:

WPS wifi connect:

Factory reset:

3.Prepare

3.1 What you need

To stream music wirelessly to OP2200V through Wi-Fi, you need:

- a certified Wi-Fi router
- an iOS or Android device, such as an iPod touch/iPhone/iPad or an Android phone or tablet
- the OPURES app available on Apple App Store (for iOS devices) or Google Play Store (for Android devices)

Your OP2200V should be connected to the same local network as your iOS or Android device through the Wi-Fi router.

3.2 Download OPURES App to your iOS or Android device

- 1) For iPod touch/iPhone/iPad user, please install OPURES from Apple App Store, and then run the app.
- 2) For Android smartphones or tablets user, please install OPURES from Google Play Store and then run the app.
- 3) Or download by scanning the QR code:

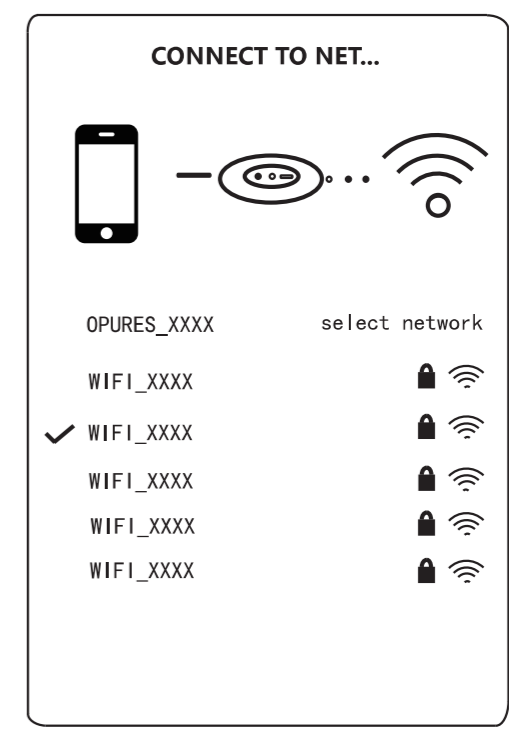
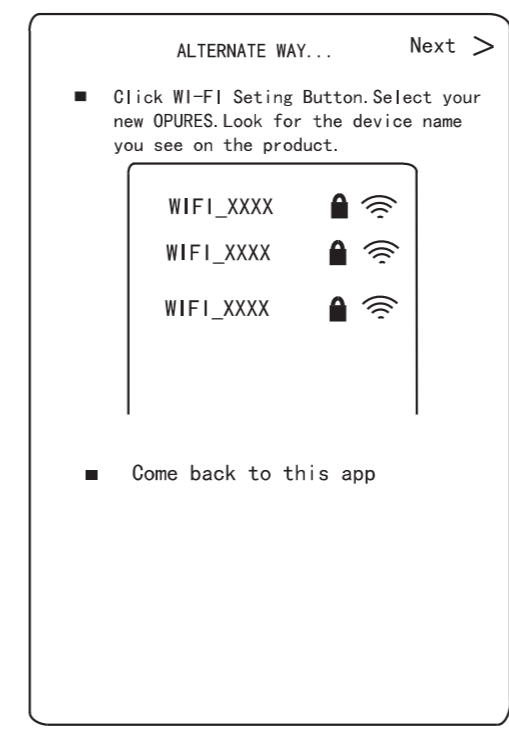
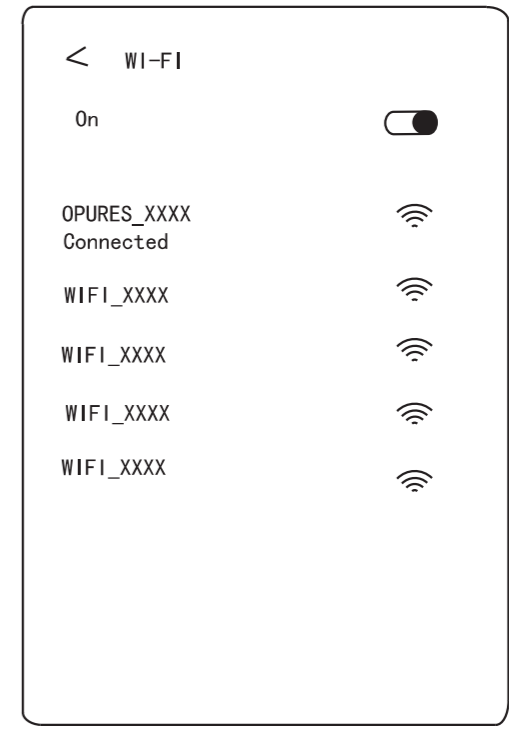
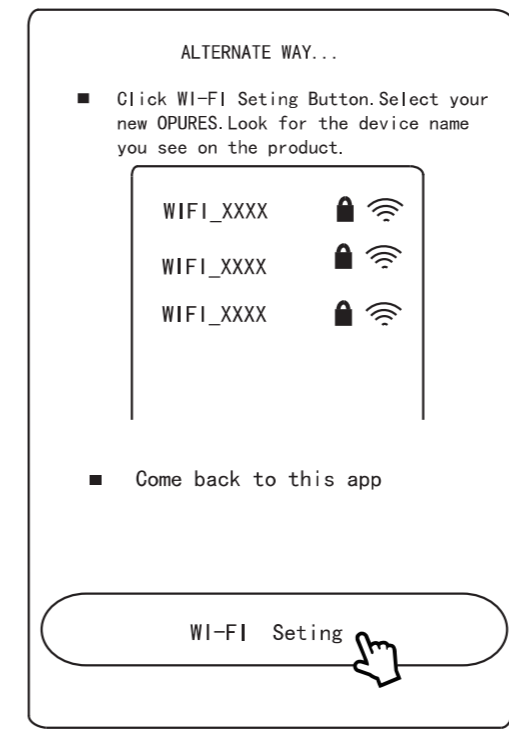

4) Open OPURES APP, after automatic detection of the speaker successfully, slide to "My Music", select local songs to play.

7) If the speaker prompts "WiFi connected", APP prompts "Setup failed". Please check whether there's any limit to access to the router connection, or tap "Try Again" and make sure that you enter the right wifi password to reconnect the speaker .

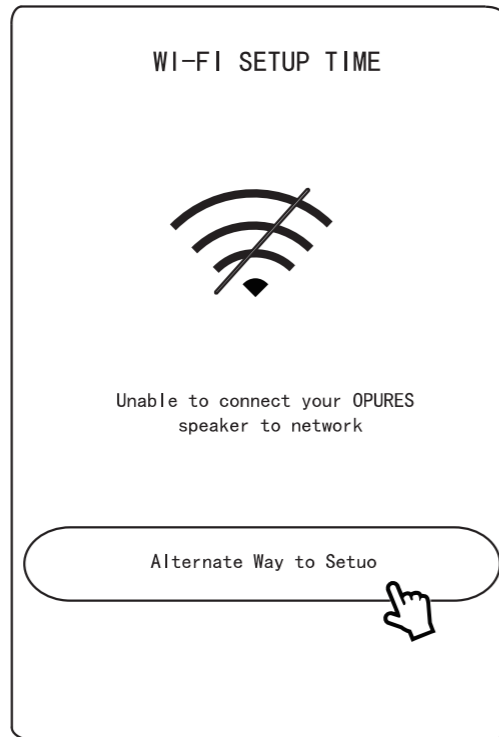

5.Direct connect to WiFi speaker

- 1) Without the internet connection, OPURES WIFI speaker can directly connect to mobile phone and playback music. OPURES APP can playback local songs on the phone.
- 2) Before setup, make sure that the device is on the Bluetooth source.
- 3) Open the iOS or Android device WiFi settings, select the OP2200V WiFi SSID like OPURES_XXXX from the list of available Wi-Fi networks. If instructed, enter the password of your home Wi-Fi network.

3.3 Connect Power and switch on

To connect the AC power adaptor to the DC IN socket on the side of the speaker.

- Plug in the DC power to the DC power socket
- Switch on the speaker
- The speaker status indicator lights on

4.Connect OP2200V to your home Wi-Fi network

- 1) To connect OP2200V to your existing home Wi-Fi network, you need to apply your home Wi-Fi setting to OP2200V.
- 2) Before connection of OP2200V to your home Wi-Fi network, make sure your Wi-Fi router is powered on and working properly, and the speaker has been powered on successfully.
- 3) Once connected successfully, OP2200V will remember your home Wi-Fi settings.
- 4) Whenever OP2200V is powered on, it is connected to your home Wi-Fi network automatically.

4.1 Set up through an iOS or Android device.

Different phones may display different images on the page.

- 1) Before setup, make sure that your iOS or Android device is connected to your home Wi-Fi network.
- 2) As instructed on the OPURES APP, tap into "WiFi Setup Wizard". In the "Wi-Fi INFO" page, enter the password of your home Wi-Fi network, and then tap next.

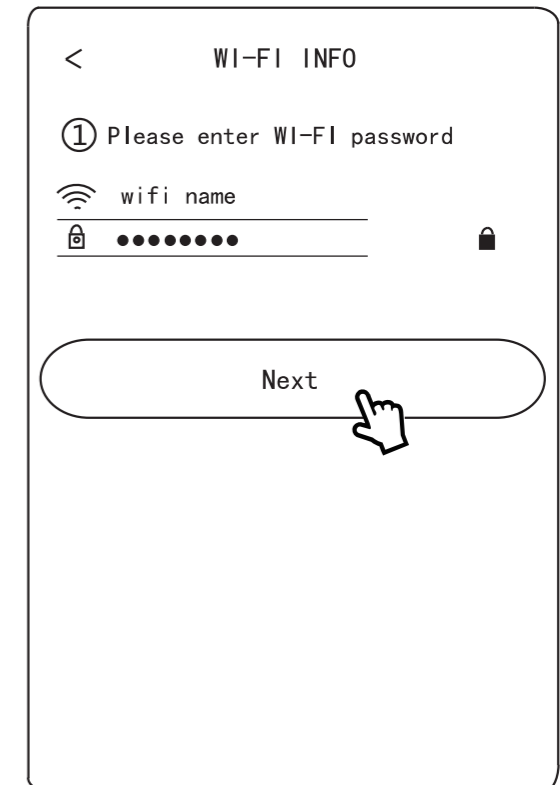

3) As instructed, press the “WPS” button, and then wait for wifi connection.

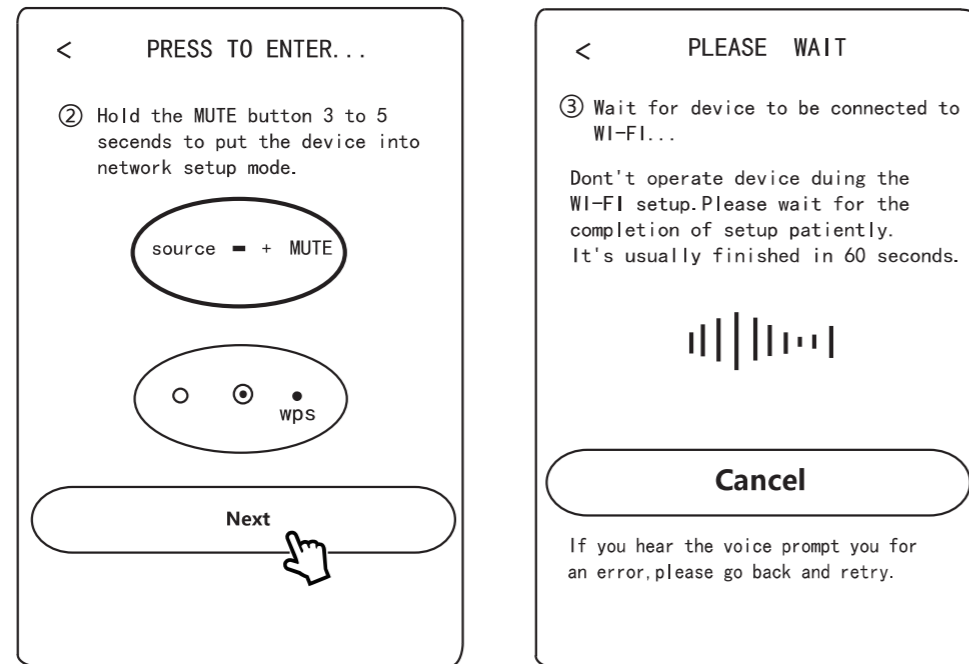

4) 4. Speaker prompts "WiFi connected", APP instructed "CONNECTED", tap "Next", you can customize the device name.

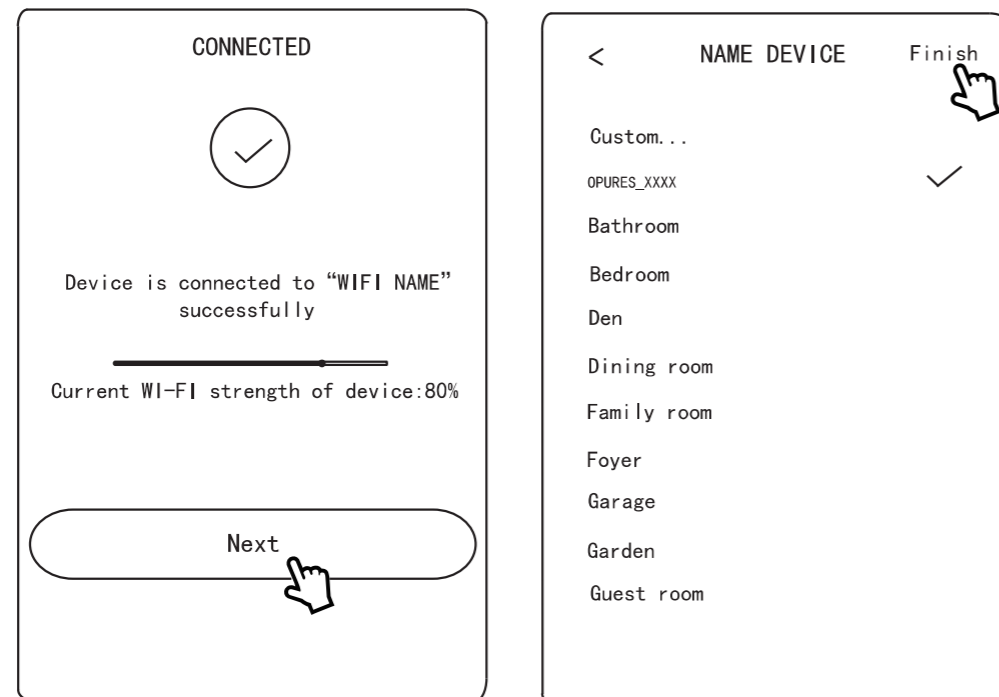

5) You can choose “Sign in with Amazon”. After login, you can talk to Alexa or tap “cancel” to enter the next page.

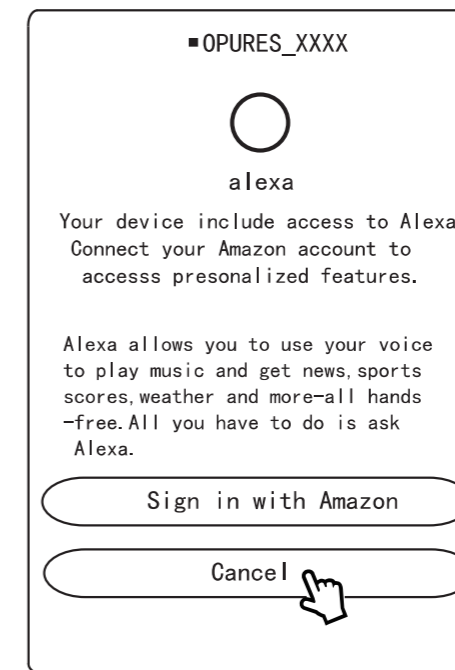

6) Select music server and play your favorite music.

