

# Easy Start Guide

MODEL  
HW550-3G



This guide will help you setup the device for internet connection and wireless networking. Before you continue, ensure that the internet connection is working on your 3G USB modem and on your ADSL/Cable Modem.

## HW550-3G Device Overview

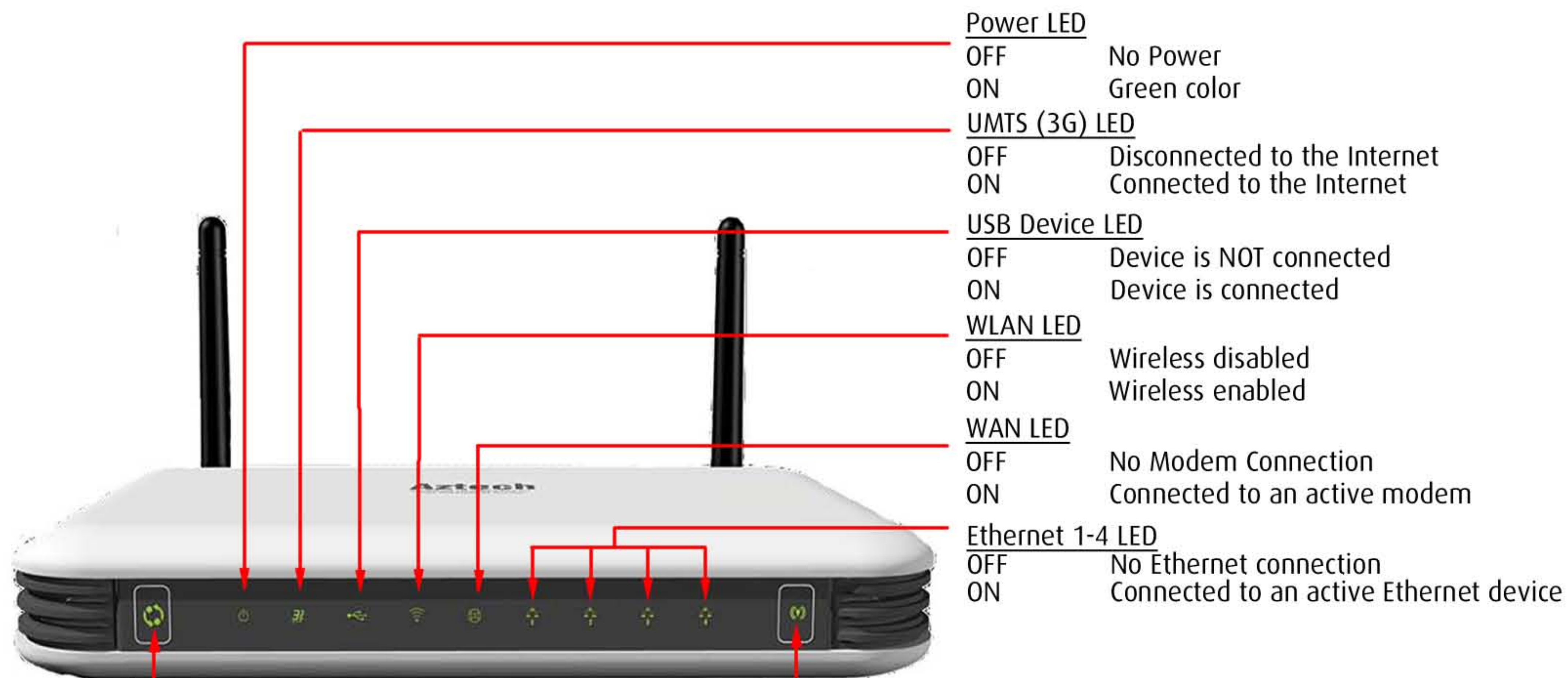

<b>Power LED</b>	OFF	No Power
	ON	Green color
<b>UMTS (3G) LED</b>	OFF	Disconnected to the Internet
	ON	Connected to the Internet
<b>USB Device LED</b>	OFF	Device is NOT connected
	ON	Device is connected
<b>WLAN LED</b>	OFF	Wireless disabled
	ON	Wireless enabled
<b>WAN LED</b>	OFF	No Modem Connection
	ON	Connected to an active modem
<b>Ethernet 1-4 LED</b>	OFF	No Ethernet connection
	ON	Connected to an active Ethernet device

**Connect/Disconnect Button**

- Allows you to control your 3G Mobile broadband Internet connection without going in to the Web UI.

**WPS Button**

- Press for two seconds (or until the LED blinks) to start WPS pairing.  
- Wireless client must be WPS-enabled and must be pressed within 2 min.

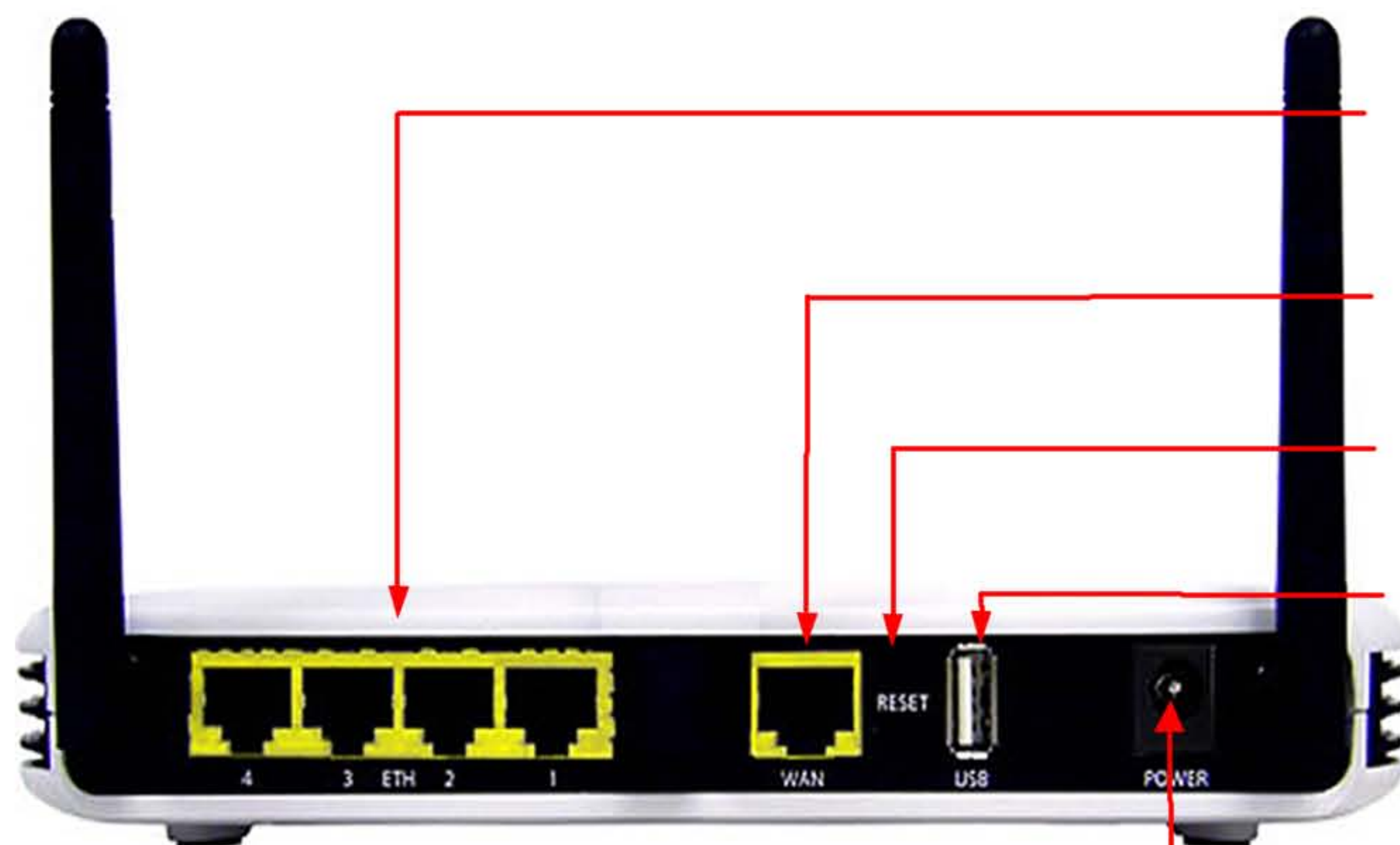

- Ethernet Port 1-4**  
- Connecting to computers/devices using an Ethernet cable
- WAN Port**  
- Connecting to ADSL/Cable modem using an Ethernet cable
- Reset Button**  
- Press for 3 seconds to reset the Router to default settings
- USB Port**  
- Connecting to 3G USB Modem  
- USB Mass storage, printers and alike
- Power Jack**  
- Connect +12V, 1A DC Power Adapter

## Setup Diagram using 3G USB Modem

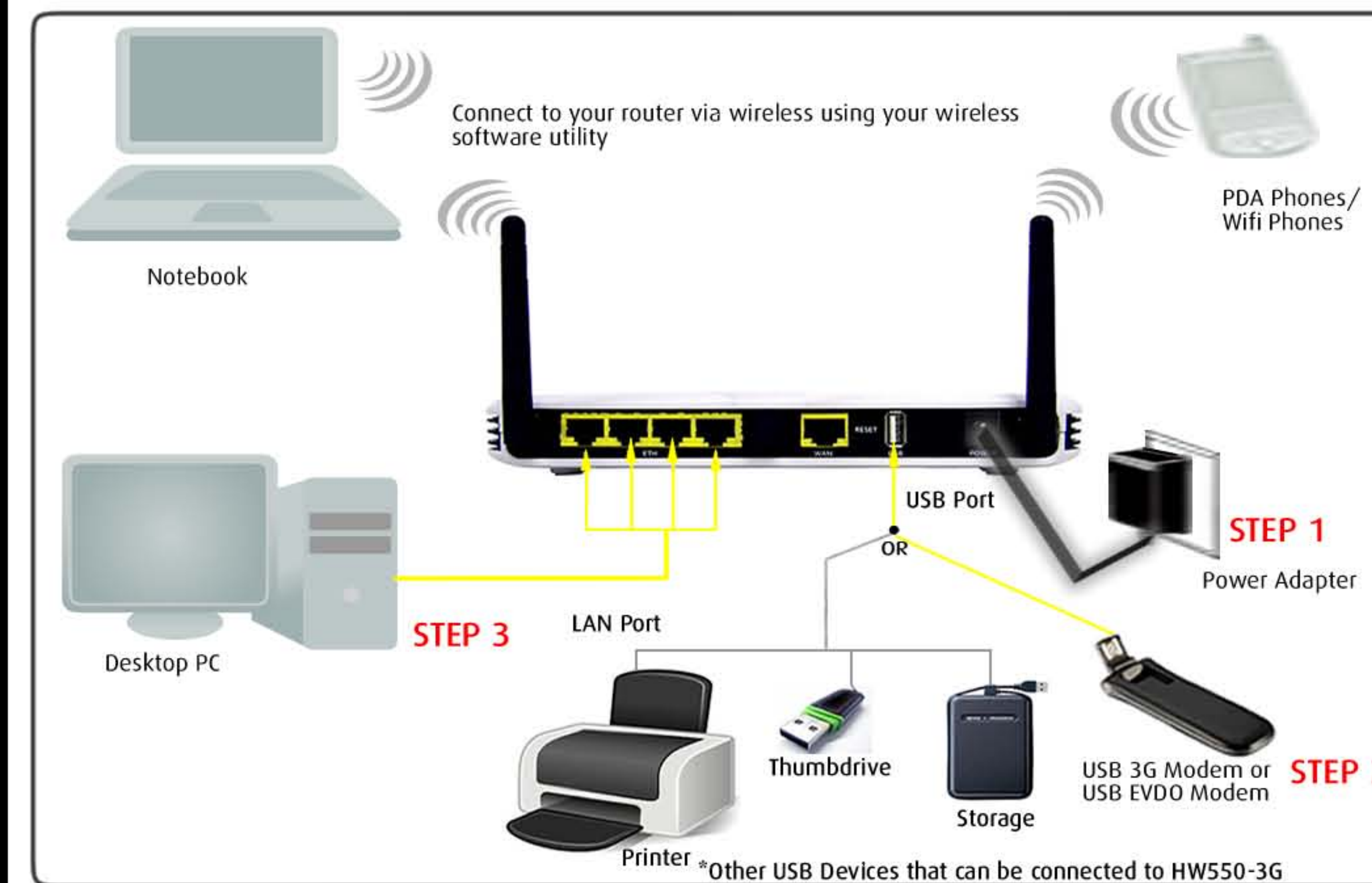

**Step 1**

- Connect the power adapter to the power jack, then plug it into the wall socket.

**Step 2**

- Connect your USB 3G Modem or USB EVDO Modem to the router's USB port.

**Step 3**

- Connect your computer to the router's LAN port using an Ethernet cable to any of the available ethernet ports

**Note:**

- You can connect to the router via wireless using the wireless client software utility.

## Connecting to the Internet using 3G Broadband

To Connect to the Internet via the Web User Interface:

1. Open your Internet web browser. Type <http://192.168.2.1> in the address bar and press enter. This opens the login authentication page.
2. Type your Username and Password. Your default Username and Password is admin/admin.
3. Click the Wizard Tab, follow the step-by-step guide on how to set up the router.
4. Select the Time zone from the drop down box then click 'Next' to continue.
5. Select Mobile Broadband Internet Connection type then click 'Next' to continue.  
For Mobile Broadband Internet connection type, you are required to have the following:
  - a.) USB 3G Modem or USB EVDO Modem
  - b.) Broadband data SIM card for USB 3G Modem
6. For 3G Access Point Settings select 'List' then choose your Country, Internet Service Operator and the APN on the drop down box.  
Username and Password – Some ISP may require a Username and Password set by the Operators. Please contact your ISP if you do not have this information  
Choose your preferred Connection Method:  
Connect Manually – This connection method requires you to manually press the 'Connect' button each time Internet connection is required. Please note that the Internet connection will not be disconnected unless you manually press the 'Disconnect' button.  
Always connected – This connection method allows your Internet connection to be always ON. You need to manually press the 'Disconnect' button when Internet connection is not required.
7. Setup your wireless connection, check Wireless Enabled to activate your wireless connection and set the SSID for your HW550-3G. Click 'Next' to continue.
8. Under Summary page verify the settings made click 'Apply' for the settings to take effect.



## Setup Diagram using ADSL/Cable Modem

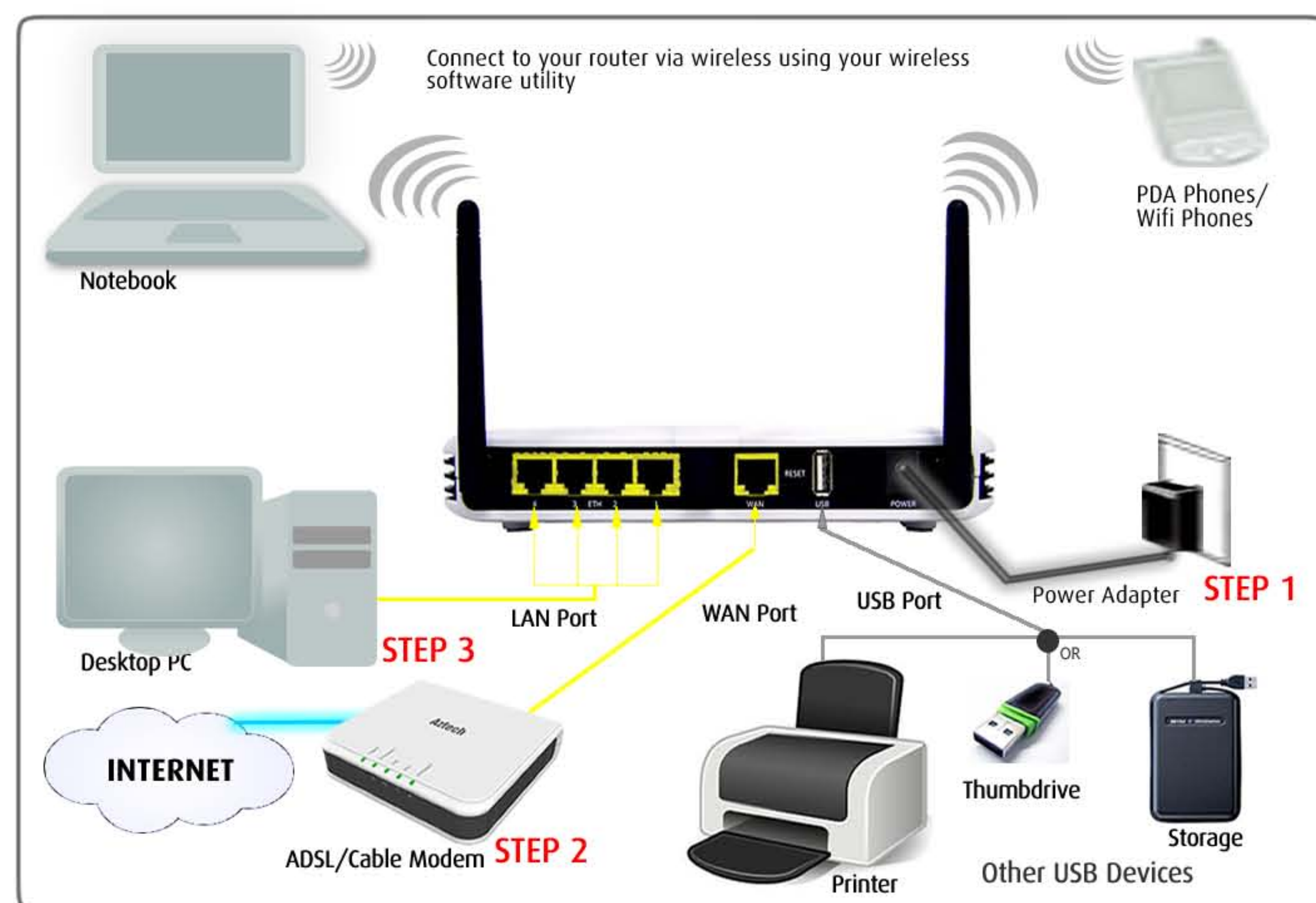

**Step 1**  
- Connect the power adapter to the power jack, then plug it into the wall socket.

**Step 2**  
- Connect your ADSL/Cable Modem to the router's WAN port.

**Step 3**  
- Connect your computer to the router's LAN port using an Ethernet cable to any of the available ethernet ports.

**Note:**  
You can connect to the router via wireless using the wireless client software utility. Please ensure that your modem's LAN IP address does not conflict the router's IP address.

To change your router's IP Address:

By default your router's IP address is 192.168.2.1, if your modem is on the same subnet (192.168.2.x) follow the steps on how to change the router's IP address.

1. Login to the WEB GUI, then click Advanced Mode.
2. Under Networking Tab go to Local then change the Router's IP address, Primary DNS and Default Gateway IP address. Make sure that the Router, Primary DNS and Default Gateway are on the same subnet (example: 192.168.1.x).



## Connecting to your router via Wireless

By default your wireless connection is 'Enabled'. Follow the steps on how to change the default settings. This allows you to configure your basic wireless settings.

1. Under Basic Mode go to Quick Setup, under Wireless pane change the settings.
2. Check the Wireless Enabled box to enable your wireless connection.
3. Check the Broadcast SSID box to broadcast your HW550-3G wireless network name. You may change the SSID set on your HW550-3G.
4. Check the WPA Enabled box to enable your wireless security. This will ensure wireless security on your network. You may change the Passphrase set on your router. Click 'Apply' for the settings to take effect.



5. Using your wireless client utility, search for the HW550-3G SSID and click 'Connect'.

## Connecting to the Internet using ADSL/Cable Modem

To Connect to the Internet via the Web User Interface:

1. Open your Internet web browser. Type <http://192.168.2.1> in the address bar and press enter. This opens the login authentication page.
2. Type your Username and Password. Your default Username and Password is admin/admin.
3. Click the Wizard Tab, follow the step-by-step guide on how to set up the router.
4. Select the Time zone from the drop down box then click 'Next' to continue.
5. Select Ethernet WAN under Internet Connection type then click 'Next' to continue.  
For Ethernet WAN Internet connection type, you are required to have the following:
  - a.) ADSL/Cable Modem
  - b.) Active Internet Service Account
6. Under Connection Method drop down box select DHCP, your HW550-3G will automatically get an IP address from the DHCP server or from your ISP.
7. Setup your wireless connection, check Wireless Enabled to activate your wireless connection and set the SSID for your HW550-3G. Click 'Next' to continue.
8. Under Summary page verify the settings made click 'Apply' for the settings to take effect.

**Note:** Ensure that your router's IP address does not conflict with your ADSL/Cable modem.